

Shah
Pritchard

**TOWN AND COUNTRY PLANNING
(GENERAL PERMITTED DEVELOPMENT) ORDER 1995**

DIRECTION MADE UNDER ARTICLE 4(1)

BIGGIN HILL AIRPORT

WHEREAS the Council of the London Borough of Bromley, being the appropriate local planning authority within the meaning of Article 4(6) of the Town and Country Planning (General Permitted Development) Order 1995 are satisfied that it is expedient that the development of the descriptions set out in the Schedule below should not be carried out on the land shown edged red on the attached plan, unless permission is granted on an application made under Part III of the Town and Country Planning Act 1990

NOW THEREFORE the said Council in pursuance of the power conferred upon them by Article 4(1) of the Town and Country Planning (General Permitted Development Order) 1995 hereby direct that the permission granted by Article 3 of the said Order shall not apply to development on the said land of the descriptions set out on the Schedule below

THE SCHEDULE

The carrying out on operational land by a relevant airport operator or its agent of development (including the erection or alteration of an operational building) in connection with the provision of services and facilities at a relevant airport within the scope of Class A of Part 18 of Schedule 2 to the 1995 Order PROVIDED THAT nothing herein shall prevent development which falls within the scope of paragraph A.4 of Class A of Part 18 of Schedule 2 to the 1995 Order.

NOTE: References in this Direction to the 1995 Order mean the Town and Country Planning (General Permitted Development) Order 1995/418.

GIVEN under the Common Seal of the London Borough of Bromley of Civic Centre Stockwell

Close Bromley BR1 3UH this 4th day of January 2000 2001.

THE COMMON SEAL OF)
THE SAID COUNCIL was)
hereunto affixed in the)
presence of :-)

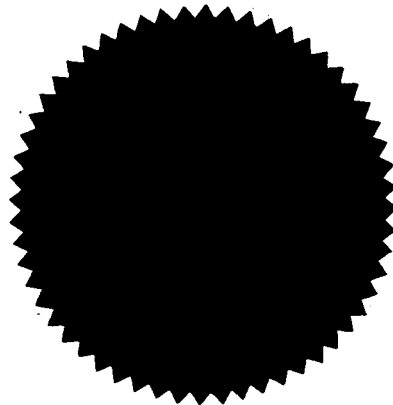

Authorised Signatory

David Howe

Mayor

Erin Clements

Chief Legal Officer

PRINCIPAL SOLICITOR

The Secretary of State for the Environment, Transport and the Regions hereby approves the foregoing direction.

Signed by authority of the Secretary of State.....

Andrew Melville

ANDREW MELVILLE
Director, London Co-ordination & Environment
Division in the Government Office for London

8 January 2001

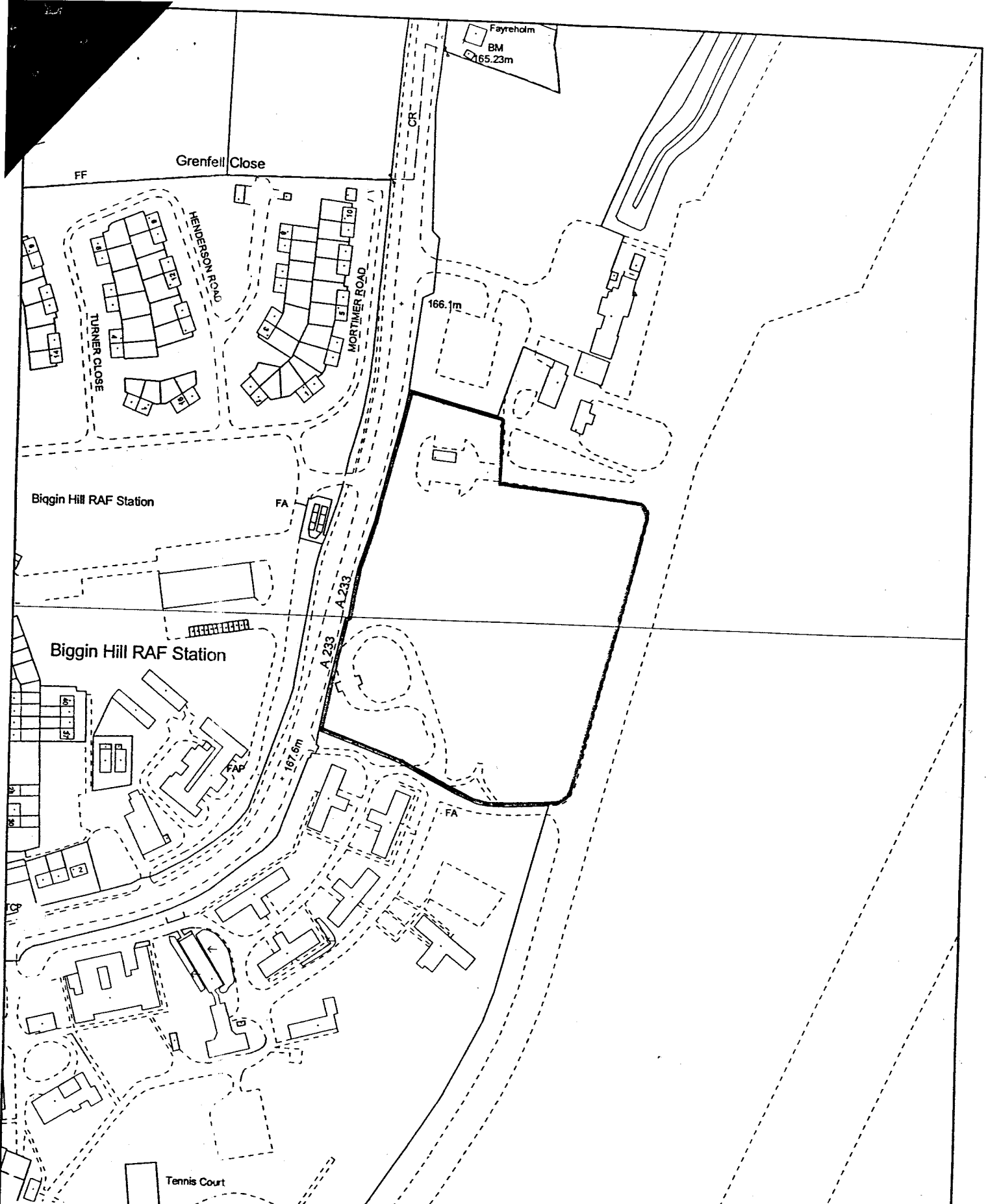

This map is reproduced from Ordnance Survey material with the permission of Ordnance Survey on behalf of the Controller of Her Majesty's Stationery Office © Crown copyright. Unauthorised reproduction infringes Crown copyright and may lead to prosecution or civil proceedings. London Borough of Bromley. Lic. No. LA086320 2000

**ENVIRONMENTAL SERVICES
DEPARTMENT**



STUART MACMILLAN
CHIEF PLANNER,
CIVIC CENTRE, STOCKWELL CLOSE,
BROMLEY, KENT, BR1 3UH.
Tel: 020 8464 3333

**ARTICLE 4 DIRECTION
CONCERNING
LAND AT BIGGIN HILL AIRPORT,
MAIN ROAD, BIGGIN HILL.**

Scale 1:2500



05/10/00

B.H. 9a

U.P.R.N.	10390/2050/2/000	Sub U.P.R.N.s		How	1/1
Flat		Property Name	Land South Of Tower	Number	
Street	Churchill Way		(,)
District	Biggin Hill Airport		Locality	Biggin Hill	
Town	Westerham		County	Kent	
Postcode		Grid Ref. (E)	541382	(N)	161025
					Quadrant

Date Built		Parish		Ward	
Property Type		Status		Landuse	
Alternative Refs.		Area	m ²	Digital Map Ref.	
Constraints		Type		Status	

Property Menu
Main Menu

Property Details 2
Property History

Planning Info.
Copy Property

PR_STRPRO