

Existing Block Plan

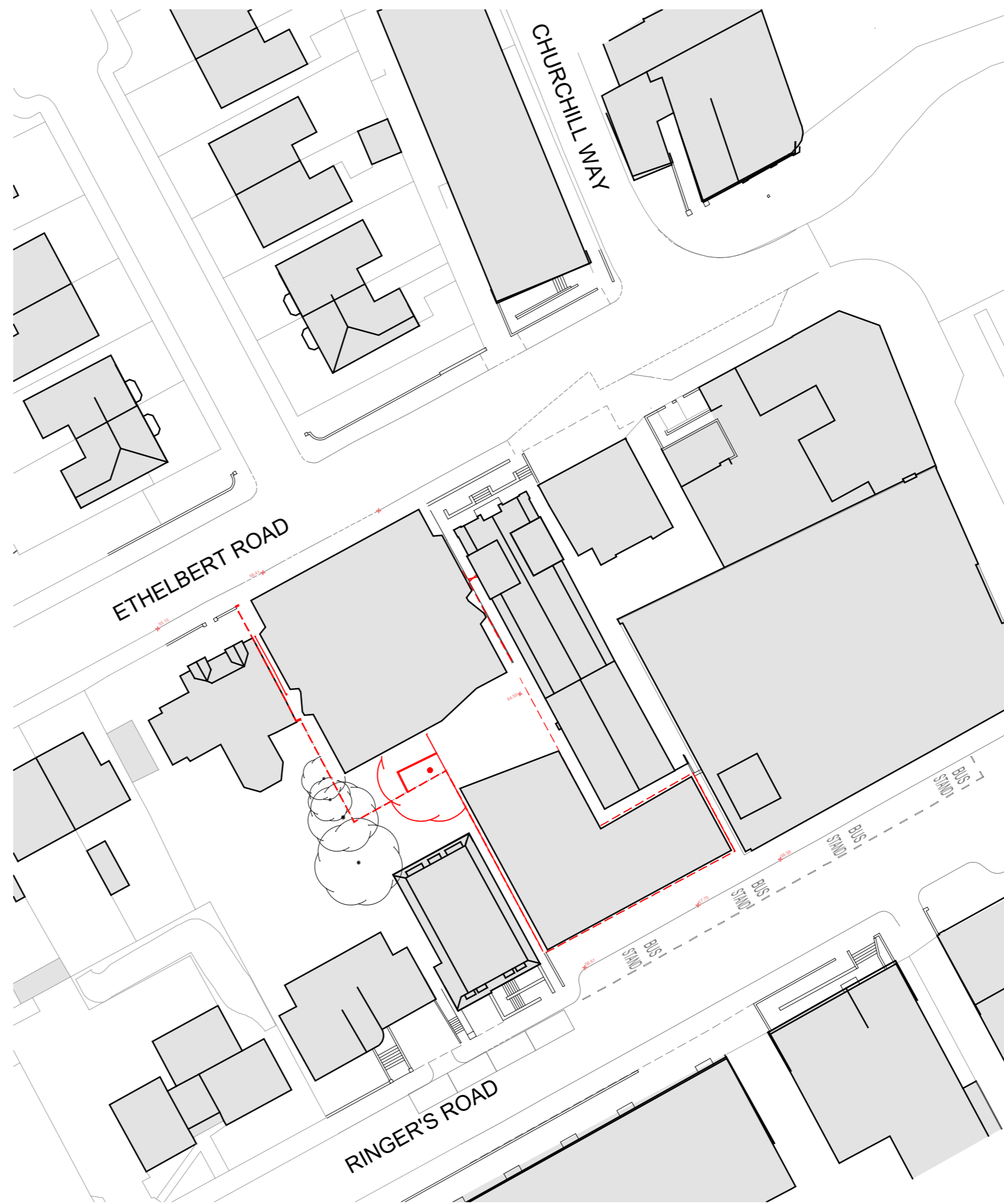

Proposed Block Plan

□ Site Boundary

Hollaway

London | 10a Acton Street | London | WC1X 9NG
 T +44 (0) 20 7096 5425 | E london@hollawaystudio.co.uk | W www.hollawaystudio.co.uk
 Kent | The Tramway Stables | Rampart Road | Hythe | Kent | CT21 5BG
 T +44 (0)1303 260 515 | E kent@hollawaystudio.co.uk | W www.hollawaystudio.co.uk

Project | Ringers Road
 Bromley

Client | The Substantia Group

Title | Existing & Proposed Block Plan

Status | PRELIMINARY

Scale@A2 | 1:200 Date | 21.01.21 Drawn | GG Chk'd | LC

Project Number
18.085
 Bim Number

Drawing Number
100.02

Revision
R0

